

FUTRUS® CUBICA HYBRID SINK MODULE

SPECIFICATION SHEET

FUTRUS
SOLUTIONS WITH CORIAN® DESIGN

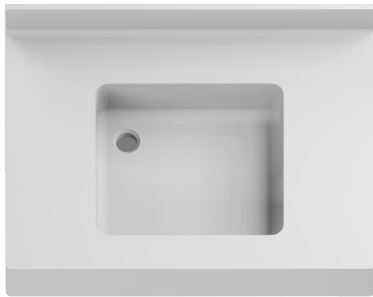

STANDARD FEATURES

- Sink and counter made with 100% Corian®
- Standard or offset drain location
- Optional overflow integration
- Corian® resists scratching, staining, chipping & impacts
- Corian® is seamless & nonporous
- Corian® is bleach cleanable
- ADA compliant
- Corian® is GREENGUARD certified to resist mold and bacteria growth

MODULE DETAILS

- Overall Unit Size: 30" W x 21" D x 34" H
- Features the Cubica F1614 sink
16-1/4" W x 14-3/4" D x 5-1/4" Deep
- 5-1/2" front apron
- Eased edges typical
- Square outside corner with 1/2" radius or 4" radius outside corner
- 4" coved Corian® backsplash
- Laminate or thermofoil base
- Matching plumbing access panel with security screws
- Available as fully enclosed for spaces requiring tamper resistance

STANDARD CORIAN® COLORS

- _00 Glacier White
- _01 Cameo White
- _02 Bisque
- _03 Bone
- _04 Vanilla
- _11 Linen

BASE COLORS

- _LC Laminate Cherry
- _LM Laminate Maple
- _LW Laminate Walnut
- _TC Thermofoil Cherry
- _TM Thermofoil Maple
- _TW Thermofoil Walnut

Additional colors available, contact Futrus®

SPECIFICATION NO.

DESCRIPTION

FHSM1614_AP_FR_[CORIAN COLOR]_[BASE COLOR]	Futrus Cubica Sink Module with laminate or thermofoil access panel; finished right end
FHSM1614_AP_FL_[CORIAN COLOR]_[BASE COLOR]	Futrus Cubica Sink Module with laminate or thermofoil access panel; finished left end
FHSM1614_AP_FBE_[CORIAN COLOR]_[BASE COLOR]	Futrus Cubica Sink Module with laminate or thermofoil access panel; finished both ends

*Add _ENC to end of specification for fully enclosed base ideal for behavioral health applications

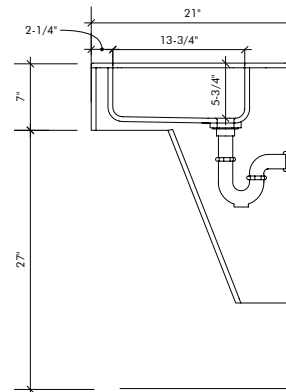

TYPICAL ADA LAYOUT

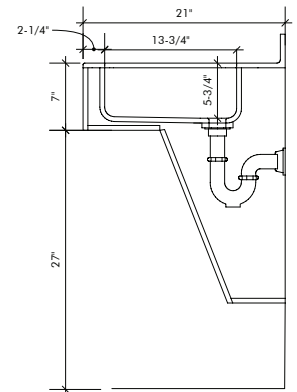

TYPICAL ADA LAYOUT TAMPER RESISTANT/FULLY ENCLOSED

futrus.com
info@futrus.com
1.877.FUTRUS1 (388.7871)