

FUTRUS® COMPAX SHOWER SYSTEM CORIAN® NEO-ANGLE SHOWER BASE AND WALLS WITH STANDARD THRESHOLD

FUTRUS®
SOLUTIONS WITH CORIAN® DESIGN

designed with

CORIAN®
SOLID SURFACE

MODEL FCOMPAX_S

Specification Sheet

Division 22 Plumbing Manufacturers

FEATURES

- Made with Corian®
- Seamless & bleach cleanable
- GREENGUARD® to resist mold, virus & bacteria growth
- Low maintenance
- Impact & chip resistant
- Anti-slip
- Meets ANSI & CSA National Consensus Standards
- Easy Installation

STANDARD CORIAN® COLOR OPTIONS

Color*	Code	Description
	00	Glacier White
	01	Cameo White
	02	Bisque
	03	Bone
	04	Silver Gray
	05	Vanilla

Color tiles are for reference only*
[See full Corian® color choices](#)

OPTIONAL UPGRADES

Code	Description
SC	Straight Corners*
HI	Half-Inch walls**

Standard is coved corners*
Standard is 1/4"***



CERTIFICATIONS

- Complies with the requirements in CSA B45.5/IAPMO Z124 standard for plastic plumbing fixtures and the requirements in the HUD Use of Materials Bulletin No. 73a.
- Futrus® Shower Bases are listed by Home Innovation Research Labs and UL as meeting the requirements of the Uniform Plumbing Code, the International Plumbing Code and are listed by ULC as meeting the requirements of the National Plumbing Code of Canada.
- NSF/ANSI Standard 51 certified
- GREENGUARD certified to resist the growth of viruses, bacteria & mold
- GREENGUARD Gold low VOC emissions
- Contributes to LEED certification credits
- Class 1 (Class A) fire rated

FUTRUS® COMPAX SHOWER SYSTEM CORIAN® NEO-ANGLE SHOWER BASE AND WALLS WITH STANDARD THRESHOLD



designed with



MODEL FCOMPAX_S

Specification Sheet

Division 22 Plumbing Manufacturers

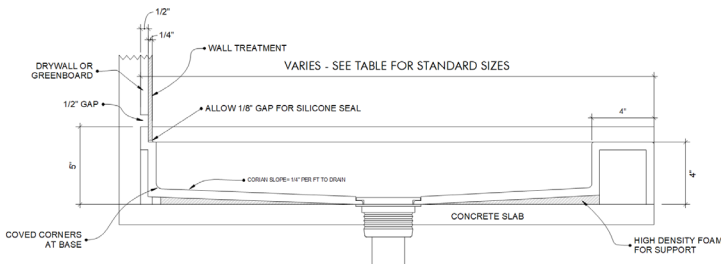

Side Cross Section

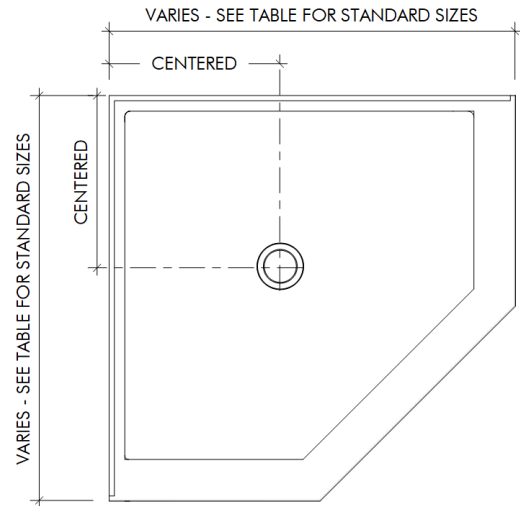

Top View

STANDARD SIZES

Dimensions (Inches)

Code	Width	Depth	Height
FCOMPAX_S_3030	30"	30"	96"
FCOMPAX_S_3232	32"	32"	96"
FCOMPAX_S_3434	34"	34"	96"
FCOMPAX_S_3636	36"	36"	96"
FCOMPAX_S_3838	38"	38"	96"
FCOMPAX_S_4040	40"	40"	96"
CUSTOM			

TECHNICAL INFORMATION

- All dimensions are nominal
- Futrus® 1-year limited warranty
- Corian® 10-year material warranty

EXAMPLE MODEL SPECIFICATION

FCOMPAX_S_3636_GLACIERWHITE
(Model_Length_Depth_Corian Color_Optional Extra)

RECOMMENDED SPECIFICATION

To be specified in Division 22 Plumbing Manufacturers. The Futrus Compax Shower System, Model FCOMPAX_S. Shower base and walls to be made of 100% Corian solid surface with no polyester blends. Shower base must feature a self-draining, non-slip surface. Must comply with the requirements in CSA B45.5/ IAPMO Z124 standard for plastic plumbing fixtures and the requirements in the HUD Use of Materials Bulletin No. 73a and be listed by Home Innovation Research Labs and UL as meeting the requirements of the Uniform Plumbing Code, the International Plumbing Code and listed by ULC as meeting the requirements of the National Plumbing Code of Canada. Shower base and walls to be NSF/ANSI Standard 51 certified; GREENGUARD certified to resist the growth of viruses, bacteria & mold; GREENGUARD Gold low VOC emissions; Contribute to LEED certification credits; Class 1 (Class A) fire rated.