

# FUTRUS® VURSO ADA SHOWER SYSTEM

## CORIAN® SQUARE SHOWER BASE AND WALLS WITH LOW THRESHOLD

FUTRUS®  
SOLUTIONS WITH CORIAN® DESIGN

designed with

CORIAN®  
SOLID SURFACE

### MODEL FVURSO\_S\_ADA

Specification Sheet

Division 22 Plumbing Manufacturers

#### FEATURES

- Made with Corian®
- Seamless & bleach cleanable
- GREENGUARD® to resist mold, virus & bacteria growth
- Low maintenance
- Impact & chip resistant
- Anti-slip
- Meets ANSI & CSA National Consensus Standards
- Easy Installation

#### STANDARD CORIAN® COLOR OPTIONS

Color*	Code	Description
	00	Glacier White
	01	Cameo White
	02	Bisque
	03	Bone
	04	Silver Gray
	05	Vanilla

Color tiles are for reference only\*

[See full Corian® color choices](#)

#### OPTIONAL UPGRADES

Code	Description
SC	Straight Corners*
HI	Half-Inch walls**

Standard is covered corners\*

Standard is 1/4"\*\*\*



#### CERTIFICATIONS

- Complies with the requirements in CSA B45.5/IAPMO Z124 standard for plastic plumbing fixtures and the requirements in the HUD Use of Materials Bulletin No. 73a.
- Futrus® Shower Bases are listed by Home Innovation Research Labs and UL as meeting the requirements of the Uniform Plumbing Code, the International Plumbing Code and are listed by ULC as meeting the requirements of the National Plumbing Code of Canada.
- NSF/ANSI Standard 51 certified
- GREENGUARD certified to resist the growth of viruses, bacteria & mold
- GREENGUARD Gold low VOC emissions
- Contributes to LEED certification credits
- Class 1 (Class A) fire rated

# FUTRUS® VURSO ADA SHOWER SYSTEM CORIAN® SQUARE SHOWER BASE AND WALLS WITH LOW THRESHOLD

FUTRUS®  
SOLUTIONS WITH CORIAN® DESIGN

designed with

CORIAN®  
SOLID SURFACE

## MODEL FVURSO\_S\_ADA

Specification Sheet

Division 22 Plumbing Manufacturers

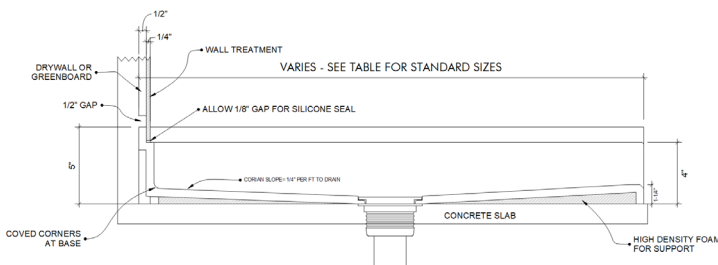

Side Cross Section

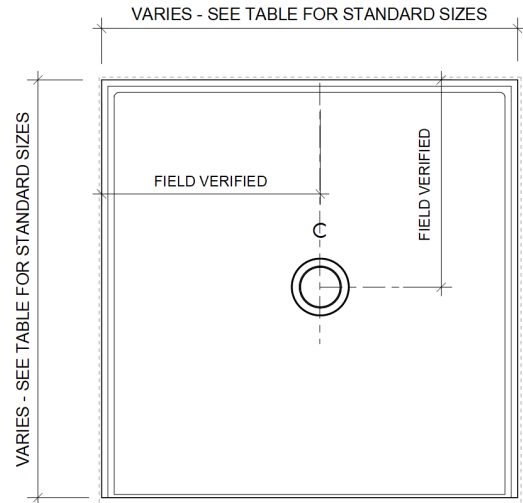

Top View

### STANDARD SIZES

#### Dimensions (Inches)

Code	Width	Depth	Height
FVURSO_S_ADA_3030	30"	30"	96"
FVURSO_S_ADA_3232	32"	32"	96"
FVURSO_S_ADA_3636	36"	36"	96"
FVURSO_S_ADA_4242	42"	42"	96"
FVURSO_S_ADA_4848	48"	48"	96"
CUSTOM			

### TECHNICAL INFORMATION

- All dimensions are nominal
- Futrus® 1-year limited warranty
- Corian® 10-year material warranty

### EXAMPLE MODEL SPECIFICATION

FVURSO\_S\_ADA\_3636\_GLACIERWHITE  
(Model\_Length\_Depth\_Corian Color\_Optional Extra)

### RECOMMENDED SPECIFICATION

**To be specified in Division 22 Plumbing Manufacturers.** The Futrus Vurso ADA Shower System, Model FVURSO\_S\_ADA. Shower base and walls to be made of 100% Corian solid surface with no polyester blends. Shower base to feature an ADA compliant threshold, self-draining and non-slip surface. Must comply with the requirements in CSA B45.5/IAPMO Z124 standard for plastic plumbing fixtures and the requirements in the HUD Use of Materials Bulletin No. 73a and be listed by Home Innovation Research Labs and UL as meeting the requirements of the Uniform Plumbing Code, the International Plumbing Code and listed by ULC as meeting the requirements of the National Plumbing Code of Canada. Shower base and walls to be NSF/ANSI Standard 51 certified; GREENGUARD certified to resist the growth of viruses, bacteria & mold; GREENGUARD Gold low VOC emissions; Contribute to LEED certification credits; Class 1 (Class A) fire rated.