

FUTRUS® INFINITI SHOWER NICHE CORIAN® SHOWER NICHE WITH SEAMLESSLY INTEGRATED SHELF

FUTRUS®
SOLUTIONS WITH CORIAN® DESIGN

designed with

CORIAN®
SOLID SURFACE

MODEL FSNICHE

Specification Sheet

Division 22 Plumbing Manufacturers

FEATURES

- Made with Corian®
- Seamless & bleach cleanable
- GREENGUARD® Certified to resist mold, virus & bacteria growth
- Low maintenance
- Impact & chip resistant
- Easy Installation



- Infiniti Shower Niche - Seamless

STANDARD CORIAN® COLOR OPTIONS

Color*	Code	Description
	00	Glacier White
	01	Cameo White
	02	Bisque
	03	Bone
	04	Silver Gray
	05	Vanilla

Color tiles are for reference only*
[See full Corian® color choices](#)

OPTIONAL UPGRADES

Code	Description
DI	Drop-In*

Standard is seamless *



- Infiniti Shower Niche - Drop-In

CERTIFICATIONS

- Complies with the requirements in CSA B45.5/IAPMO Z124 standard for plastic plumbing fixtures and the requirements in the HUD Use of Materials Bulletin No. 73a.
- NSF/ANSI Standard 51 certified
- GREENGUARD certified to resist the growth of viruses, bacteria & mold
- GREENGUARD Gold low VOC emissions

FUTRUS® INFINITI SHOWER NICHE CORIAN® SHOWER NICHE WITH SEAMLESSLY INTEGRATED SHELF

FUTRUS®
SOLUTIONS WITH CORIAN® DESIGN

designed with



MODEL FSNICHE

Specification Sheet

Division 22 Plumbing Manufacturers

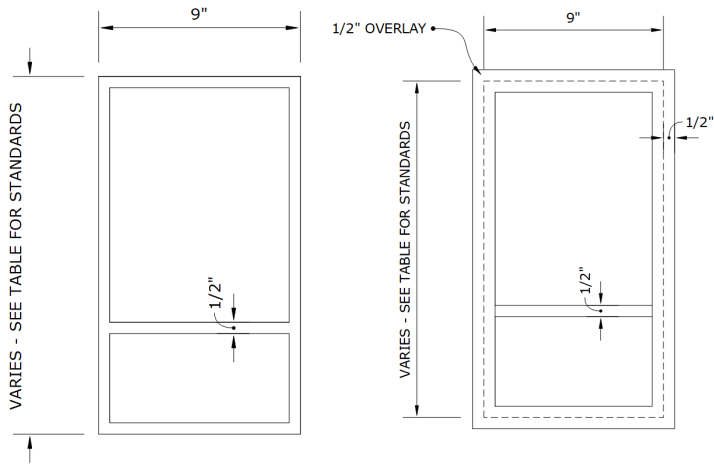

Front Elevation - Seamless

Front Elevation - Drop-In

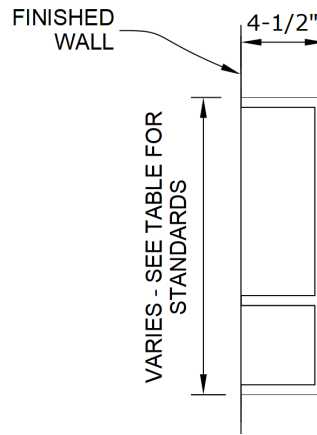

Side Section - Seamless

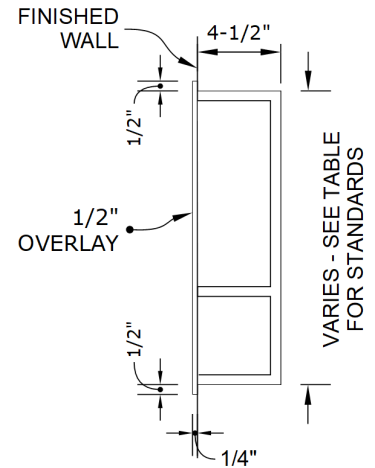

Side Section - Drop-In

STANDARD SIZES

Dimensions (Inches)

Code	Length	Width	Depth
FSNICHE_30	30"	9"	14-1/2"
FSNICHE_32	32"	9"	14-1/2"
FSNICHE_34	34"	9"	14-1/2"
FSNICHE_36	36"	9"	14-1/2"
FSNICHE_38	38"	9"	14-1/2"
FSNICHE_40	40"	9"	14-1/2"
CUSTOM			

RECOMMENDED SPECIFICATION

To be specified in Division 22 Plumbing

Manufacturers. The Futrus Infiniti Shower Niche, Model FSNICHE. Niche to be made of 100% Corian solid surface with no polyester blends. Must comply with the requirements in CSA B45.5/IAPMO Z124 standard for plastic plumbing fixtures and the requirements in the HUD Use of Materials Bulletin No. 73a. Shower base and walls to be NSF/ANSI Standard 51 certified; GREENGUARD certified to resist the growth of viruses, bacteria & mold; GREENGUARD Gold low VOC emissions; Contribute to LEED certification credits; Class 1 (Class A) fire rated.

TECHNICAL INFORMATION

- All dimensions are nominal
- Futrus® 1-year limited warranty
- Corian® 10-year material warranty

EXAMPLE MODEL SPECIFICATION

FSNICHE_32_GLACIERWHITE_DI
(Model_Length_Corian Color_Upgrade)