



# FUTRUS® F-SERIES CORIAN® DOOR SYSTEM

A RANGE OF CORIAN® SOLID SURFACE DOOR STYLES WITH EMBEDDED HINGE CONNECTIONS THAT ARE FULLY COMPATIBLE WITH PRE-EXISTING TRADITIONAL CASEWORK

**FUTRUS**  
SOLUTIONS WITH CORIAN® DESIGN



The F-Series Corian Door System offers superior hygiene, durability, and life cycle, compared with traditional doors made of laminate, wood or metal. Made with seamless, bleach cleanable Corian solid surface, which is Greenguard Certified to resist the growth of viruses, bacteria and mold to support the highest standards of infection control and reduce the risk of Hospital Acquired Infections (HAIs). Corian surfaces also resist dents, scratches, chipping and eliminate the risk of delamination, commonly associated with traditional casework doors, for superior life cycle. This unique door system also provides impact resistant protection for base cabinets. Featuring a range of adaptable door styles to meet the needs of any casework application and patented, embedded metal hinge connections for maximum strength attachment to traditional casework. Available in standard or custom door sizes, a range of hardware options and all Corian colors to compliment any design scheme.

## STANDARD FEATURES

- Made with 3/4" Corian® solid surface
- Available up to 96"H
- Front Profiles: Standard, Cove Edge or Glass Insert
- Door Back Profiles: Standard or Infection Control (Coved)
- Hinge: Stainless, Soft Close, ANSI or MRI Compliant non-ferrous
- Fastening technology provides for traditional case construction connections (particle board, melamine or plywood)
- Pulls: Tabs, Steel C-pull, Integral
- Drawers: Constructed with all Corian®, powder coated metal box or stainless

## CUSTOMIZATIONS

- Drawer locks
- Selection of hardware
- Cabinet interiors: Coved, sealed
- Radius corners and edges
- Integrated door vents
- Integrated PPE dispenser

## STANDARD CORIAN® COLORS

Color*	Code	Description
	GW	Glacier White
	CW	Cameo White
	BI	Bisque
	BN	Bone
	VY	Silver Gray
	NL	Vanilla

Color tiles are for reference only\* See all color options on futrus.com

- All Corian® surfaces
- Bleach cleanable
- Seamless & nonporous
- Resists dents, scratches, chipping & impacts
- Standard & custom sizes
- Patented impeded hinge connections
- Range of door styles
- Choice of hinge styles (included)
- Available in all Corian® colors
- GREENGUARD® certified to resist mold & bacteria

For complete product specifications visit [futrus.com](http://futrus.com)

## FUTRUS® DOOR DETAILS

Solid Corian® Doors available up to 96"H

## FUTRUS® DOOR DETAILS

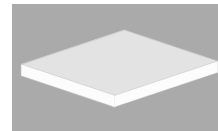

Standard Profile  
Style 132

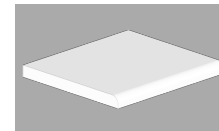

Cove Edge Profile  
Style 150

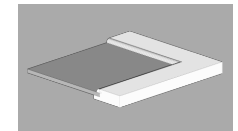

Glass Insert  
Style 140

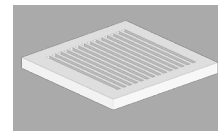

Ventilation Cutout Profile  
Style 144

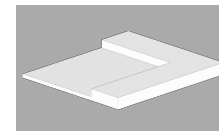

Standard Square Profile  
Style 133



Standard Square Profile



Ventilation Cutout Profile

Futrus LTD All Rights Reserved. Copying or distribution of Futrus designs, in whole or in part, is strictly prohibited.

[futrus.com](http://futrus.com)  
[info@futrus.com](mailto:info@futrus.com)  
1.877.FUTRUS1 [388.7871]