

FUTRUS® MAGNAGUARD HYBRID MRI CASEWORK
CASEWORK SYSTEM DESIGNED FOR USE WITH MAGNETIC
IMAGING SYSTEMS, FEATURING CORIAN® EXTERIOR SURFACES
& LAMINATE OR THERMOFOIL INTERIOR COMPONENTS



designed with



MODEL HMAG

Specification Sheet

Division 12 FF&E

FEATURES

- Made with Corian®
- Patented non-ferrous construction
- Bleach cleanable
- Seamless & nonporous
- Resists scratching, staining, chipping & impacts
- Adaptable design
- Available in all Corian® colors
- Available in a range of thermofoil & laminate colors
- GREENGUARD® Certified to resist mold, virus & bacteria growth

STANDARD CORIAN® COLOR OPTIONS

Color*	Code	Description
	GW	Glacier White
	CW	Cameo White
	BI	Bisque
	BN	Bone
	VY	Silver Gray
	NL	Vanilla

Color tiles are for reference only*
See full Corian® color choices at Futrus.com

STANDARD LAMINATE COLOR OPTIONS

Color*	Code	Description
	LW / TW	Laminate Walnut / Thermofoil Walnut
	LC / TC	Laminate Cherry / Thermofoil Cherry
	LM / TM	Laminate Maple / Thermofoil Maple
	LA1 / T1	Laminate White / Thermofoil White
	LA2 / T2	Laminate Black / Thermofoil Black

Color tiles are for reference only*
See full Corian® color choices at Futrus.com



CERTIFICATIONS

- GREENGUARD certified to resist the growth of viruses, bacteria & mold
- GREENGUARD Gold low VOC emissions
- Contributes to LEED certification credits
- Class 1 (Class A) fire rated

FUTRUS® MAGNAGUARD HYBRID MRI CASEWORK
CASEWORK SYSTEM DESIGNED FOR USE WITH MAGNETIC
IMAGING SYSTEMS, FEATURING CORIAN® EXTERIOR SURFACES
& LAMINATE OR THERMOFOIL INTERIOR COMPONENTS



designed with



MODEL HMAG
Specification Sheet
Division 12 FF&E

WALL CABINET

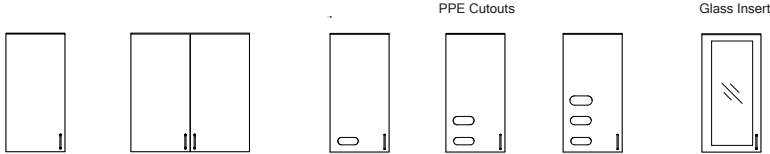

MODEL: C-WALL
(Any width over 24" will require 2 doors | Includes 2 adjustable shelves)

STANDARD SIZES

WIDTH: 18", 24", 32", 36", 42", 48"
DEPTH: 11", 14", 18"
HEIGHT: 18", 24", 32", 36", 42", 48"

BASE CABINET

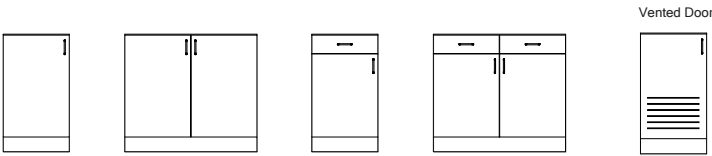

MODEL: C-BASE
(Any width over 24" will require 2 doors | Includes 1 adjustable shelf)

STANDARD SIZES

WIDTH: 18", 24", 32", 36", 42", 48"
DEPTH: 21", 24"
HEIGHT: 28", 32", 36"

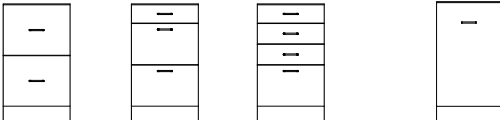

MODEL: C-DRAWER BASE
MODEL: C-BIN
(Pull out drawer for standard 13 gallon trash bin)

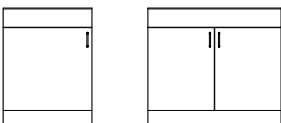

MODEL: C-SINK BASE
(Any width over 24" will require 2 doors | Includes 1 adjustable shelf)

TALL CABINET

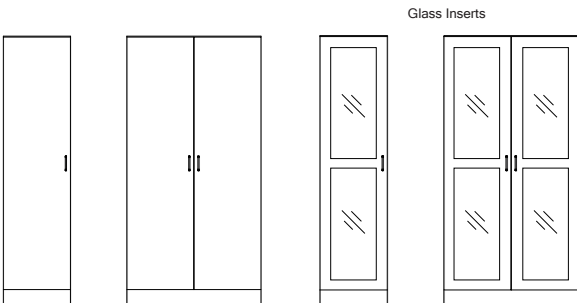

MODEL: C-TALL
(Any width over 24" will require 2 doors | Includes 4 adjustable shelves & 1 center fixed shelf)

STANDARD SIZES

WIDTH: 18", 24", 36", 48"
DEPTH: 21 / 22", 24 / 25"
HEIGHT: 60", 72", 84", 96"

