

FUTRUS® MAGNAGUARD MRI CASEWORK

CORIAN® CASEWORK SYSTEM DESIGNED FOR USE WITH MAGNETIC IMAGING SYSTEMS

FUTRUS
SOLUTIONS WITH CORIAN® DESIGN

MODEL MAG

Specification Sheet

Division 12 FF&E

designed with

CORIAN®
SOLID SURFACE

FEATURES

- 100% Corian® surfaces
- Patented non-ferrous construction
- Bleach cleanable
- Seamless & nonporous
- Resists scratching, staining, chipping & impacts
- Adaptable design
- Doors, drawers & case built with Corian® solid surface
- GREENGUARD® Certified to resist mold, virus & bacteria growth
- Available in all Corian® colors

STANDARD CORIAN® COLOR OPTIONS

Color*	Code	Description
	GW	Glacier White
	CW	Cameo White
	BI	Bisque
	BN	Bone
	VY	Silver Gray
	NL	Vanilla

Color tiles are for reference only*
See full Corian® color choices at Futrus.com

CERTIFICATIONS

- GREENGUARD certified to resist the growth of viruses, bacteria & mold
- GREENGUARD Gold low VOC emissions
- Contributes to LEED certification credits
- Class 1 (Class A) fire rated



FUTRUS® MAGNAGUARD MRI CASEWORK

CORIAN® CASEWORK SYSTEM DESIGNED FOR USE WITH MAGNETIC IMAGING SYSTEMS

FUTRUS
SOLUTIONS WITH CORIAN® DESIGN

designed with

CORIAN®
SOLID SURFACE

MODEL MAG

Specification Sheet

Division 12 FF&E

WALL CABINET

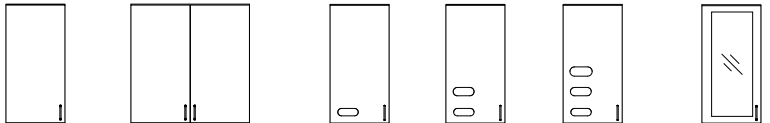

MODEL: C-WALL

(Any width over 24" will require 2 doors | Includes 2 adjustable shelves)

STANDARD SIZES

WIDTH: 18", 24", 32", 36", 42", 48"

DEPTH: 11", 14", 18"

HEIGHT: 18", 24", 32", 36", 42", 48"

BASE CABINET

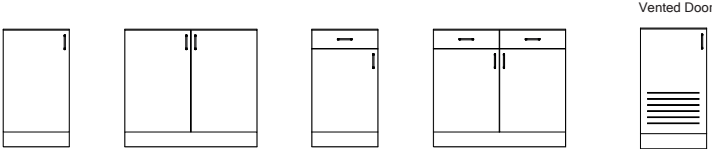

MODEL: C-BASE

(Any width over 24" will require 2 doors | Includes 1 adjustable shelf)

STANDARD SIZES

WIDTH: 18", 24", 32", 36", 42", 48"

DEPTH: 21", 24"

HEIGHT: 28", 32", 36"

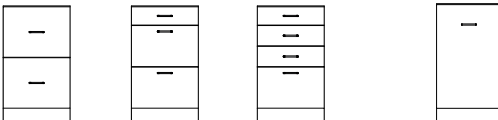

MODEL: C-DRAWER BASE

MODEL: C-BIN

(Pull out drawer for standard 13 gallon trash bin)

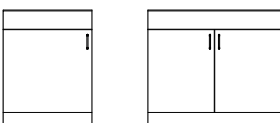

MODEL: C-SINK BASE

(Any width over 24" will require 2 doors | Includes 1 adjustable shelf)

TALL CABINET

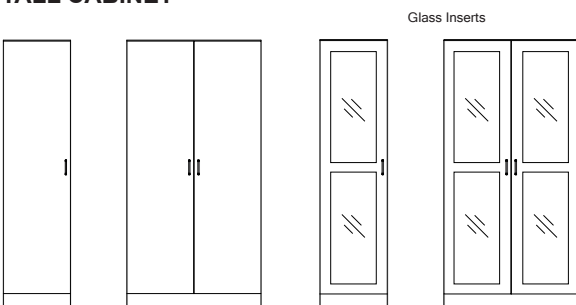

MODEL: C-TALL

(Any width over 24" will require 2 doors | Includes 4 adjustable shelves & 1 center fixed shelf)

STANDARD SIZES

WIDTH: 18", 24", 36", 48"

DEPTH: 21 / 22", 24 / 25"

HEIGHT: 60", 72", 84", 96"

FUTRUS® MAGNAGUARD MRI CASEWORK

CORIAN® CASEWORK SYSTEM DESIGNED FOR USE WITH MAGNETIC IMAGING SYSTEMS

FUTRUS
SOLUTIONS WITH CORIAN® DESIGN

designed with

CORIAN®
SOLID SURFACE

MODEL MAG

Specification Sheet

Division 12 FF&E

FUTRUS® DOOR STYLES

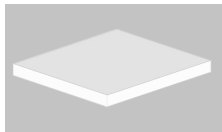

Standard Profile
132

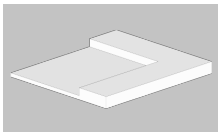

Standard Square Profile
133

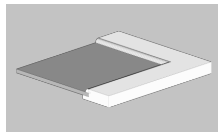

Glass Insert
140

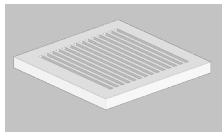

Ventilation Cutout Profile
144

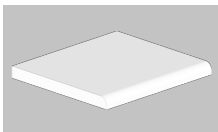

Cove Edge Profile
150

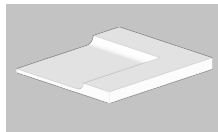

Infection Control Profile
155

FUTRUS® DOOR PULL OPTIONS

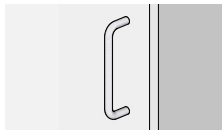

4" C-Pull (Standard)
C-Pull

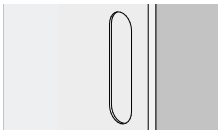

Integrated Pull
Int-Pull

FUTRUS® SHELVING STYLE

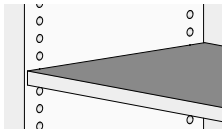

Adjustable Shelves (Standard)
Adj.

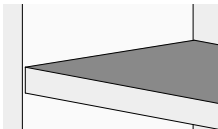

Fixed Shelves
Fixed.

FUTRUS® CABINET TOP

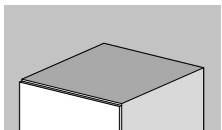

Horizontal Top (Standard)
Horizontal

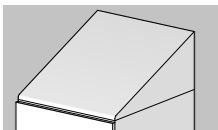

Sloped Top
Sloped

OPTIONAL UPGRADES

Code	Description
PPE	PPE Door Cutouts*
LD	Locking Doors
ST	Sloped Top
UL	Under Cabinet Lighting
ZC	Z-Clip Hanging Wall Mount [Aluminum]
PM	Platform Mount

*Not available with glass doors

TECHNICAL INFORMATION

- All dimensions are nominal
- Futrus® 5-year limited warranty
- Corian® 10-year material warranty

RECOMMENDED SPECIFICATION

The Futrus Magnaguard MRI Casework, Model MAG. MRI casework to be made of Corian® solid surface, free from ferrous materials and feature MRI compliant hardware. Casework to be GREENGUARD certified to resist the growth of viruses, bacteria & mold; GREENGUARD Gold low VOC emissions; Contribute to LEED certification credits; Class 1 (Class A) fire rated.

MODEL SPECIFICATION

MAG-
(MAG- Model Name_Corian Color_Width_Depth_Height_Drawer Qty_Door Style_Door Pull_Shelving_Optional Upgrade1_Optional Upgrade 2)
Put "X" if not applicable