

FUTRUS® PRIMA HEALTHWALL™

VERSATILE, LOW PROFILE, PANEL STYLE HEALTHWALL™



designed with



MODEL PRIMA_H

Specification Sheet

Division 10 Patient Bed Service Walls

FEATURES

- Made with Corian®
- Bleach cleanable
- Seamless & nonporous
- Resists scratching, staining, chipping & impacts
- Adaptable, modular design
- Standard & custom table sizes
- Available in a range of Corian® colors
- GREENGUARD® Certified to resist mold, virus & bacteria growth
- Available with vertical chase (left or right-handed)
- Duel integrated horizontal equipment rail & standard vertical tracks on chase
- 12 years parts & labor warranty
- 100% USA manufactured



STANDARD CORIAN® COLOR OPTIONS

Color*	Code	Description
	00	Glacier White
	01	Cameo White
	02	Bisque
	03	Bone
	04	Silver Gray
	05	Vanilla

Color tiles are for reference only*
See full Corian® color choices at Futrus.com

STANDARD OPTIONS

- Nurse Call
- Medical Gas Outlets
- Monitor Support
- Electrical & Switches
- Data & Communications

OPTIONAL UPGRADES

- Dye-sublimated images & patterns
- Backlit Panel

CERTIFICATIONS

- NSF/ANSI Standard 51 certified
- GREENGUARD certified to resist the growth of viruses, bacteria & mold
- GREENGUARD Gold low VOC emissions
- Contributes to LEED certification credits
- Class 1 (Class A) fire rated
- All components are UL listed or UL recognized
- Complies with the seismic requirements of, and is approved by, the State of California's Office of Statewide Health Planning and Development (OSPHD).
- Manufactured in accordance with the National Fire Protection Association (NFPA), NFPA-99 (current edition) and National Electric Code (NEC).

The installation contractor is responsible for compliance with all local, state, and federal codes applicable to the installation of medical gas and electrical systems.

designed with



MODEL PRIMA_H

Specification Sheet

Division 10 Patient Bed Service Walls

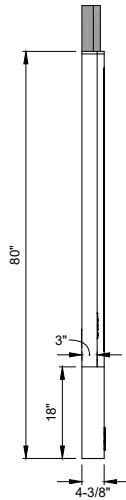

Side Elevation

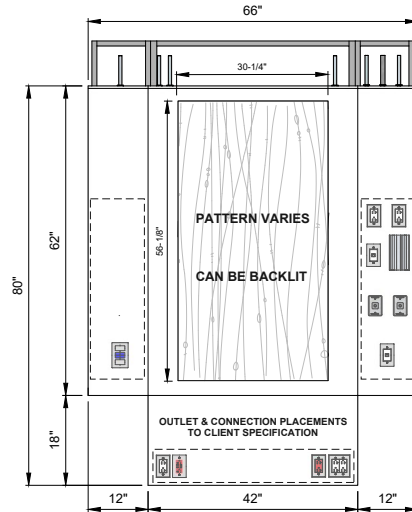

Front Elevation

STANDARD HEALTHWALL SIZE

Dimensions (Inches)

Code	Width	Height	Depth
PRIMA_H_66_80_4.375	66"	80"	4.375"
CUSTOM			

RECOMMENDED SPECIFICATION

The Futrus Prima Healthwall, Model PRIMA_H. Prima Healthwall to be made of 100% acrylic Corian® solid surface with no polyester blends. Healthwall to be NSF/ANSI Standard 51 certified; GREENGUARD certified to resist the growth of viruses, bacteria & mold; GREENGUARD Gold low VOC emissions; Contribute to LEED certification credits; Class 1 (Class A) fire rated.

Please contact Futrus for detailed specifications, sizing and quoting.

TECHNICAL INFORMATION

- All dimensions are nominal
- 12 years parts & labor warranty
- Corian® 10-year material warranty

EXAMPLE MODEL SPECIFICATION

PRIMA_H_66_80_4.375_GLACIERWHITE_REEDS
(Model_Width_Height_Depth_Corian Color_3D Texture_Optional Upgrade)