

FUTRUS® NATROSTREME TROUGH SINK MODULE

QUARTZ ANTI-SPLASHBACK OPEN DRAIN STYLE TROUGH

SINK WITH PLUMBING ENCLOSURE INCLUDED

MODEL FNSM

Specification Sheet

Division 22 Plumbing Manufacturers

FEATURES

- Made from 100% Quartz
- ADA compliant when installed according to guidelines
- Anti-splashback slope & self-draining basin
- GREENGUARD® certified to resist virus, bacteria mold growth
- Quartz resists virus, bacteria & mold growth
- Resists scratching, staining, chipping & impacts
- Seamless & nonporous
- Tamperproof plumbing enclosure
- Easy installation

POPULAR QUARTZ® COLOR OPTIONS (QC)

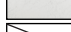
Color*	Code	Description	Price Group
	CWH	Cloud White	Group 1
	DGR	Dove Grey	Group 1
	SFL	Snow Flurry	Group 2
	SWH	Snow White	Group 2
	POR	Portoro	Group 3
	BIM	Bianco Marmor	Group 4
	ALT	Alternate Quartz	

*Color tiles are for reference only

See full standard quartz color options at futrus.com

OPTIONAL UPGRADES (OU)

Code	Description
FE	Finished Ends*
TCR	Trash cutout round
TCS	Trash cutout square
BB	Baby bowl
BS	Backsplash Shelf [for wall mounted faucets]

Standard is wall-to-wall*



STANDARD QUARTZ CERTIFICATIONS

- Complies with the requirements in CSA B45.5/IAPMO Z124 standard for plastic plumbing fixtures and the requirements in the HUD Use of Materials Bulletin No. 73a.
- Futrus® Trough Sinks are listed by Home Innovation Research Labs and UL as meeting the requirements of the Uniform Plumbing Code, the International Plumbing Code and are listed by ULC as meeting the requirements of the National Plumbing Code of Canada.
- NSF/ANSI Standard 51 certified
- Quartz is GREENGUARD certified to resist the growth of viruses, bacteria & mold
- Quartz is GREENGUARD Gold low VOC emissions
- Contributes to LEED certification credits
- Class 1 (Class A) fire rated

FUTRUS® NATROSTREME TROUGH SINK MODULE

QUARTZ ANTI-SPLASHBACK OPEN DRAIN STYLE TROUGH

SINK WITH PLUMBING ENCLOSURE INCLUDED

MODEL FNSM

Specification Sheet

Division 22 Plumbing Manufacturers

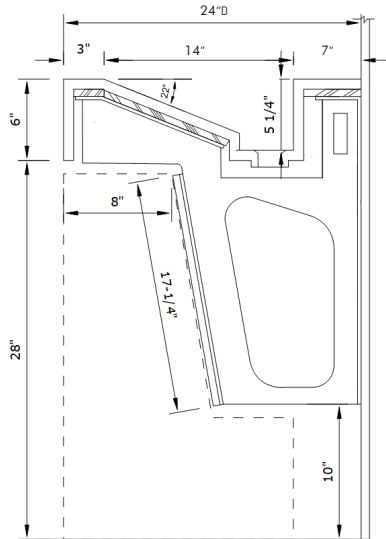

Side Cross Section

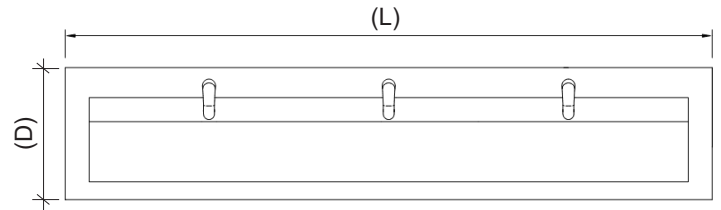

Top View

STANDARD SIZES

Trough Sink Dimensions (Inches)

Code	Length (L)	Depth (D)	Apron	Station Qty*
FNSM_24_24_5	24"	24"	5"	1
FNSM_36_24_5	36"	24"	5"	1
FNSM_48_24_5	48"	24"	5"	1
FNSM_60_24_5	60"	24"	5"	1
FNSM_72_24_5	72"	24"	5"	2
FNSM_84_24_5	84"	24"	5"	2
FNSM_96_24_5	96"	24"	5"	3
FNSM_108_24_5	108"	24"	5"	3
FNSM_120_24_5	120"	24"	5"	3
CUSTOM SIZE				

Custom lengths & configurations available*

EXAMPLE MODEL SPECIFICATION

FNSM
(MODEL _ (L) _ (D) _ (QC) _ (BSO) _ (OU))

TECHNICAL INFORMATION

- All dimensions are nominal
- Futrus® 1-year limited warranty
- Corian® 10-year limited warranty

RECOMMENDED SPECIFICATION- PLUMBING FIXTURES SECTION 22

The Futrus NatroSTREME Trough Sink Module, model FNSM. Sink and plumbing enclosure shall be made of 100% Quartz and feature a seamlessly integrated anti-splashback slope and self-draining basin. Sink designed to be ADA compliant and supplied with mounting brackets. Division 22 Plumbing Fixtures. Must be Home Innovation Research Lab & UL certified to meet Uniform Plumbing Code and International Plumbing Code requirements in USA & Canada.