

FUTRUS® SLIMLINE GRATE

METAL DRAIN GRATE TO FIT WITH THE AQUALINE AND NATROLINE TROUGH SINKS

FUTRUS
SOLID SURFACE SOLUTIONS

MODEL SLIMLINE

Specification Sheet

Division 22 Plumbing Manufacturers

FEATURES

- Made with 304 stainless steel
- Rust & corrosion resistant
- Custom sized to fit drain opening
- Comes pre-attached behind sink drain opening

STANDARD PATTERN OPTIONS (PO)

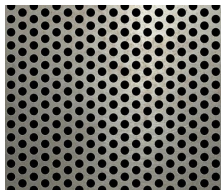

Round Perforated - RP

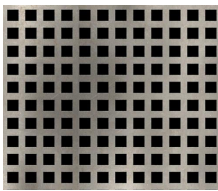

Square Perforated - SP

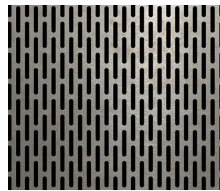

Linear Perforated - SP

TECHNICAL INFORMATION

- All dimensions are nominal
- Futrus® 1-year limited warranty
- Corian® 10-year material warranty

EXAMPLE MODEL SPECIFICATION

FSLIMLINE _ (Model) _ (PO) _ Basin Width of Installation Sink)

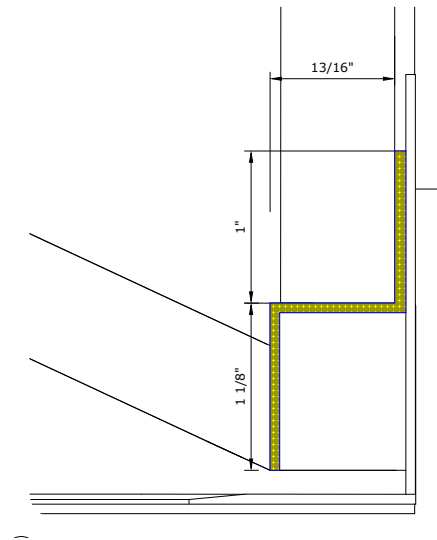
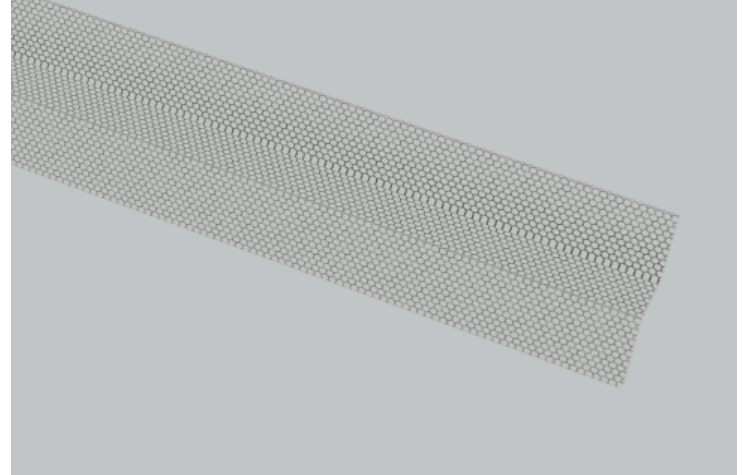

Profile

RECOMMENDED SPECIFICATION- PLUMBING FIXTURES SECTION 22

The Futrus SlimLINE Grate, model SLIMLINE. Grate shall be made of stainless steel and be rust & corrosion resistant. Division 22 Plumbing Fixtures.



futrus.com
info@futrus.com

1.877.388.FUTRUS1 [388.7871]