

# FUTRUS® SKYDEK TROUGH SINK

## DECK-FREE, ANTI-SPLASHBACK TROUGH SINK MADE WITH CORIAN® SOLID SURFACE, FOR WALL MOUNT OR BEHIND MIRROR FIXTURES

**FUTRUS**  
SOLID SURFACE SOLUTIONS

### MODEL FSDTRS

Specification Sheet

Division 22 Plumbing Manufacturers

#### FEATURES & BENEFITS

- Made from 100% acrylic solid surface
- ADA compliant when installed according to guidelines
- Anti-splash back & self-draining basin
- Bleach cleanable Corian® surfaces
- Resists scratching, staining, chipping & impacts
- Solid surfaces resist the growth of viruses, bacteria & mold
- Includes support brackets
- Easy installation & maintenance
- Customizable backsplash or luggage shelf

#### STANDARD SOLID SURFACE COLOR OPTIONS (SS)

Color*	Code	Description
	GW	Glacier White
	CW	Cameo White
	BI	Bisque
	BN	Bone
	VY	Silver Gray
	NL	Vanilla
	ALT	Alternate Solid Surface

Color tiles are for reference only\*

See full standard solid surface color options at [futrus.com](http://futrus.com)

#### OPTIONAL UPGRADES (OU)

Code	Description
FE	Finished Ends*
TCR	Trash Cutout - Round
TCS	Trash Cutout - Square
TC	Tydi Trash Cabinet
BB	Kradel Baby Bowl
LS	Luggage or Backsplash Shelf [for wall mounted faucets]

Standard is wall-to-wall\*



- SkyDEK Solid Surface Trough Sink With Backsplash

#### STANDARD SOLID SURFACE CERTIFICATIONS

- Complies with the requirements in CSA B45.5/IAPMO Z124 standard for plastic plumbing fixtures and the requirements in the HUD Use of Materials Bulletin No. 73a.
- Futrus® Trough Sinks are listed by Home Innovation Research Labs and UL as meeting the requirements of the Uniform Plumbing Code, the International Plumbing Code and are listed by ULC as meeting the requirements of the National Plumbing Code of Canada.
- NSF/ANSI Standard 51 certified
- Solid surfaces are GREENGUARD certified to resist the growth of viruses, bacteria & mold
- Solid surfaces GREENGUARD Gold low VOC emissions
- Contributes to LEED certification credits
- Class 1 (Class A) fire rated



[futrus.com](http://futrus.com)

[info@futrus.com](mailto:info@futrus.com)

1.877.388.FUTRUS1 [388.7871]

Futrus LTD All Rights Reserved Copying or distribution of this design, in whole or in part, is strictly prohibited

Futrus® is a registered trademark of Futrus LTD. Corian® is a trademark of affiliates of DuPont de Nemours, Inc. Dimensions are nominal for reference only.

Copyright © Futrus. All rights reserved.

# FUTRUS® SKYDEK TROUGH SINK

## DECK-FREE, ANTI-SPLASHBACK TROUGH SINK MADE WITH CORIAN® SOLID SURFACE, FOR WALL MOUNT OR BEHIND MIRROR FIXTURES



### MODEL FSDTRS

#### Specification Sheet

#### Division 22 Plumbing Manufacturers

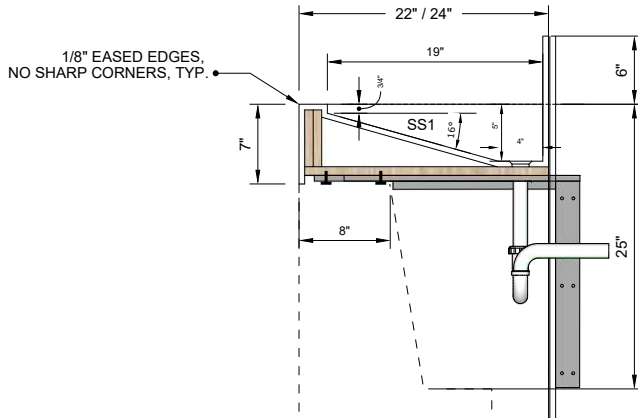

Side Cross Section

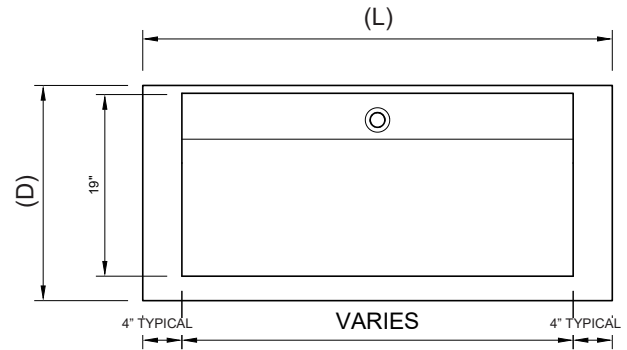

Top View

#### STANDARD SIZES

##### Trough Sink Dimensions (Inches)

Code	Length (L)	Depth (D)	Apron	Station Qty*
FSDTS_24_24/22_4.5	24"	24"/22"	7"	1
FSDTS_36_24/22_4.5	36"	24"/22"	7"	1
FSDTS_48_24/22_4.5	48"	24"/22"	7"	1
FSDTS_60_24/22_4.5	60"	24"/22"	7"	1
FSDTS_72_24/22_4.5	72"	24"/22"	7"	2
FSDTS_84_24/22_4.5	84"	24"/22"	7"	2
FSDTS_96_24/22_4.5	96"	24"/22"	7"	3
FSDTS_108_24/22_4.5	108"	24"/22"	7"	3
FSDTS_120_24/22_4.5	120"	24"/22"	7"	3
CUSTOM SIZE				

Custom lengths & configurations available\*

#### EXAMPLE MODEL SPECIFICATION

FSDTRS \_ \_ \_ \_ \_  
(MODEL \_ (L) \_ (D) \_ (QC) \_ (BSO) \_ (OU))

#### STANDARD BACKSPLASH OPTIONS (BSO)

##### Backsplash Options (Inches)

Code	Height	Depth
BS-Height	4" - 24"	2cm

##### Luggage Shelf Options (Inches)

Code	Height	Depth
LS-Height/Depth	4" - 24"	8" - 12"

#### RECOMMENDED SPECIFICATION- PLUMBING FIXTURES SECTION 22

The Futrus SkyDEK Trough Sink, model FSDTS. Sink shall be made of 100% solid surface and feature a seamlessly integrated anti-splashback slope and self-draining basin. Sink designed to be ADA compliant and supplied with mounting brackets [when required]. Division 22 Plumbing Fixtures. Must be Home Innovation Research Lab & UL certified to meet Uniform Plumbing Code and International Plumbing Code requirements in USA & Canada.



futrus.com

info@futrus.com

Futrus LTD All Rights Reserved Copying or distribution of this design, in whole or in part, is strictly prohibited

1.877.388.FUTRUS1 [388.7871]

Futrus® is a registered trademark of Futrus LTD. Corian® is a trademark of affiliates of DuPont de Nemours, Inc. Dimensions are nominal for reference only.

Copyright © Futrus. All rights reserved.