

FUTRUS ANGLE XL UNDER-MOUNT ANTI-SPLASHBACK SINK

FUTRUS
SOLUTIONS WITH CORIAN® DESIGN

designed with

CORIAN
SOLID SURFACE

MODEL F1814

Specification Sheet

Division 22 Plumbing Manufacturers

FEATURES

- Made from 100% Corian® solid surface
- Anti-Splashback slope
- Corian® resists virus, bacteria & mold growth
- Bleach cleanable
- Resists scratching & staining
- Standard with no overflow
- Offset left drain position



STANDARD CORIAN® COLOR OPTIONS

Color*	Code	Description
	00	Glacier White
	01	Cameo White
	02	Bisque
	03	Bone
	04	Silver Gray
	05	Vanilla

Color tiles are for reference only*
[See full Corian® color choices](#)



CERTIFICATIONS

All Corian® & Corian® Quartz materials are:

- GREENGUARD certified to resist the growth of viruses, bacteria & mold
- Class 1 (Class A) fire rated
- GREENGUARD Gold
- GREENGUARD Indoor Air Quality Certified
- NSF/ANSI Standard 51 certified
- Contributes to LEED certification credits

FUTRUS ANGLE XL UNDER-MOUNT ANTI-SPLASHBACK SINK

FUTRUS
SOLUTIONS WITH CORIAN® DESIGN

designed with

CORIAN
SOLID SURFACE

MODEL F1814

Specification Sheet

Division 22 Plumbing Manufacturers

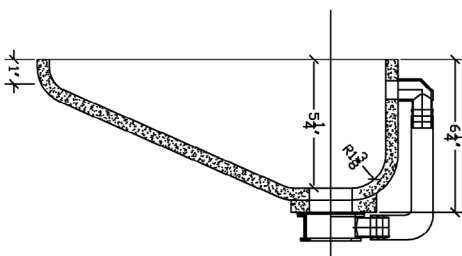

Side Cross Section

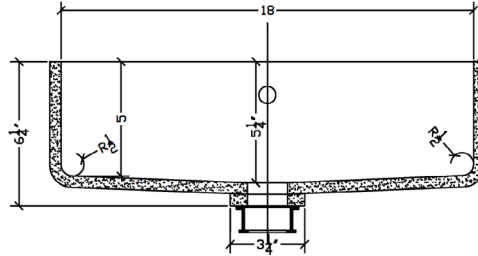

Front Cross Section

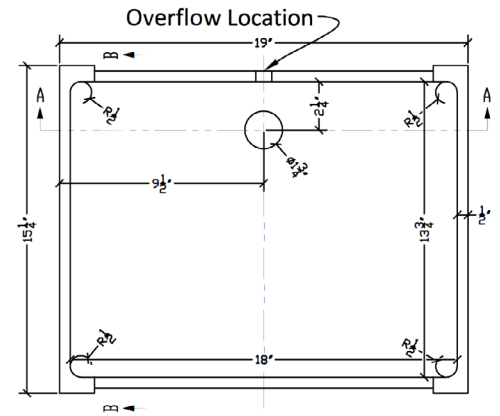

Top View

STANDARD SIZES

Inside Bowl Dimensions (Inches)

Code	Width	Length	Depth
F1814	18"	13 3/4"	5 1/4"

TECHNICAL INFORMATION

- All dimensions are nominal
- Futrus® 1-year limited warranty
- Corian® 10-year material warranty

EXAMPLE MODEL SPECIFICATION

F1814_00
(Model_Corion Color)

RECOMMENDED SPECIFICATION- PLUMBING FIXTURES SECTION 22

The Futrus Angle XL Sink, model F1814. Sink fabricated from seamless Corian®. Conforms with ANSI, UFAS and ADA standards when installed according to recommendations. Division 22 Plumbing Fixtures.